

Playground Renewal: Option 2 - Base Design



Option 2 Features:

- Rubber safety surfacing for wheelchair access to key locations
- Tree-top themed play structure with built-in shade, transfer points for children using mobility devices, unique climbing features for ages 2–12, sensory play panel and two slides
- Butterfly rocker
- Two seat spinners
- Two swings

Note: To reflect community input, the final design will feature additional inclusive play elements, including interactive play panels, a barrier-free accessible play feature and a molded bucket swing seat, all with rubber surfacing for ease of access. In response to community requests for additional swings, the existing swing set will remain, with all seats converted to belt swings.

Proposed Site Realignment Plan

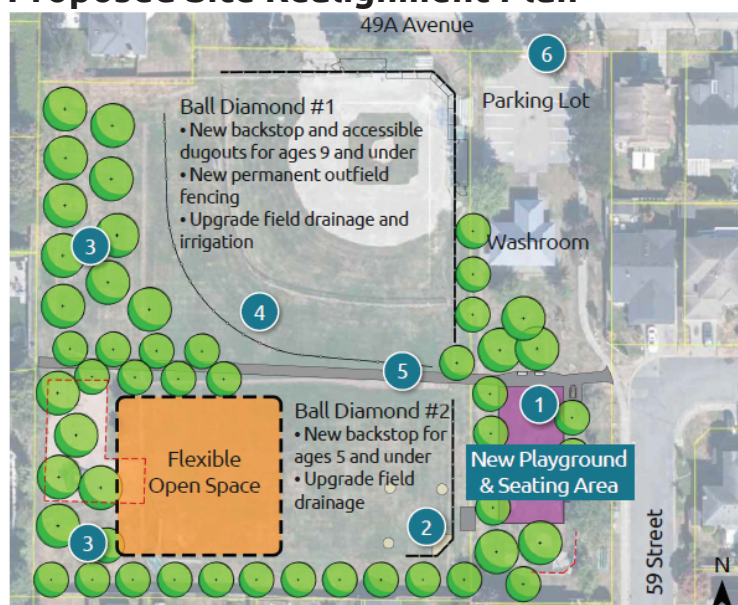

Notes:

- 1 Move playground near 59 Street for better access and add a seating area with benches and a picnic table.
- 2 Shift ball diamond to make space for new playground
- 3 Plant trees to add shade and absorb water
- 4 Improve field drainage with swales and grading as part of ball diamond upgrades
- 5 Add a central path through the park for easier access
- 6 Improve access to parking lot