

CHRISTOPHE VAISSADE
BUILDING DESIGNER
T: 604.514.6627
E: chrisva@designs.ca
WWW.CVDESIGNS.CA

**6632
LAMBERT CRESCENT
DELTA**

© COPYRIGHT. ALL DESIGNS AND THE ARCHITECTURAL ADDRESSSES THEREOF ARE THE SOLE PROPERTY OF CHRISTOPHE VAISSADE. OTHER INTELLECTUAL RIGHTS ARE RESERVED AND MAY NOT BE USED WITHOUT HIS OR HER WRITTEN PERMISSION. THIS DOCUMENT IS THE PROPERTY OF CHRISTOPHE VAISSADE AND IS NOT TO BE REPRODUCED, COPIED, OR TRANSMITTED IN ANY FORM OR BY ANY MEANS, ELECTRONIC OR MECHANICAL, WITHOUT THE WRITTEN PERMISSION OF CHRISTOPHE VAISSADE. THIS DOCUMENT IS NOT TO BE USED FOR ANY OTHER PROJECT WITHOUT THE WRITTEN PERMISSION OF CHRISTOPHE VAISSADE. CANADA COPYRIGHT ACT PUBL. 1970.

REV.	DATE	REMARKS

CLIENT :	
PROJECT :	6632 LAMBERT CRESCENT - DELTA
CONTENT :	LANDSCAPING

DATE :	APR 2025
SCALE :	1/16" = 1' 0"
PROJECT No. :	
SHEET No. :	A - 1.2
REVISION :	

PLAN OF TOPOGRAPHY SHOWING PROPOSED SUBDIVISION ON LOT 6, BLOCK 5, SECTION 13, TOWNSHIP 4, NEW WESTMINSTER DISTRICT, PLAN 16615

B.C.G.S. 92G.016

SCALE: 1:250



CIVIC: #6632 LAMBERT CRESCENT, DELTA, B.C.

PID: 010-186-891

THE INTENDED PLOT SIZE OF THIS PLAN IS
560mm IN WIDTH BY 432mm IN HEIGHT
WHEN PLOTTED AT A SCALE OF 1:250 (C SIZE)

LEGEND:

- DENOTES CONTROL MONUMENT FOUND.
- DENOTES IRON BAR POST FOUND.
- DENOTES CATCH BASIN
- DENOTES SANITARY MANHOLE
- DENOTES STORM MANHOLE.
- DENOTES LAWN BASIN.
- DENOTES POWER POLE/ UTILITY POLE.
- DENOTES POWER POLE WITH TRANSFORMER.
- DENOTES HYDRANT.
- DENOTES WATER VALVE.
- DENOTES GAS VALVE.
- DENOTES ELECTRICAL BOX.
- DENOTES LIGHT STANDARD.
- DENOTES LIGHT SIGNATURE.
- DENOTES WATER METER.
- DENOTES EXISTING RETAINING WALL ELEVATION.
- DENOTES PROPOSED ELEVATION.
- DENOTES SQUARE METRES.
- DENOTES PROPERTY LINE.
- DENOTES DIRECTION OF OVERLAND FLOW.
- DENOTES SIGN.

- NOTES:**
- ALL DISTANCES ARE SHOWN IN METRES AND DECIMALS THEREOF, UNLESS SHOWN OTHERWISE.
 - THIS PLAN LIES WITHIN INTEGRATED SURVEY AREA NO. 13 "CITY OF DELTA" NAD83(CRS) 4,0,0.B.C.1.M.V.R.D.
 - GRID BEARINGS ARE DERIVED FROM OBSERVATIONS BETWEEN CONTROL MONUMENTS 82H5387 AND 8341 (NAD83(CRS) 4,0,0.B.C.1.M.V.R.D).
 - ELEVATIONS ARE GEODETIC, SHOWN IN METRES AND DERIVED FROM CITY OF DELTA INTEGRATED MONUMENT NO. 9341 ELEV. = 96.967m (CVD28GVRD2018).
 - FEATURES SHOWN WITHOUT DIMENSIONS SHOULD BE CONFIRMED WITH WATSON AND BARNARD LAND SURVEYING.

- PROPERTY:**
- THIS PLAN IS NOT A BOUNDARY SURVEY.
 - LOT DIMENSIONS ARE DERIVED FROM PLAN 16615
 - LOT DIMENSIONS ARE SUBJECT TO CHANGE UPON SURVEY OF THE BOUNDARIES.
 - OFFSETS TO PROPERTY LINES ARE NOT TO BE USED TO DEFINE BOUNDARIES.
 - SEE RESTRICTIVE COVENANT ON TITLE: 3738436

- NOTES:**
- CURRENT ZONING: RS1
 - PROPOSED ZONING: RSS

TREE LIST

POINT #	TRUNK Ø	TYPE	CROWN Ø
995	0,20	CONF.	6,0
994	0,40	CONF.	6,0
993	0,20	CONF.	4,0
992	0,20	DECLD.	6,0
941	0,25	DECLD.	6,0
928	0,20	DECLD.	4,0
1025	0,20	CONF.	4,0
1024	0,25	CONF.	4,0
1023	0,20	DECLD.	6,0
1022	0,20	DECLD.	6,0
1021	0,20	CONF.	10,0
1020	0,20	CONF.	10,0
1019	0,20	CONF.	10,0
1018	1,20	CONF.	12,0
1017	0,40	CONF.	10,0
1016	1,20	CONF.	12,0

WATSON & BARNARD
B.C. LAND SURVEYORS
1524 58th STREET
DELTA, B.C., V4L 2A8
P: 604 943 9433

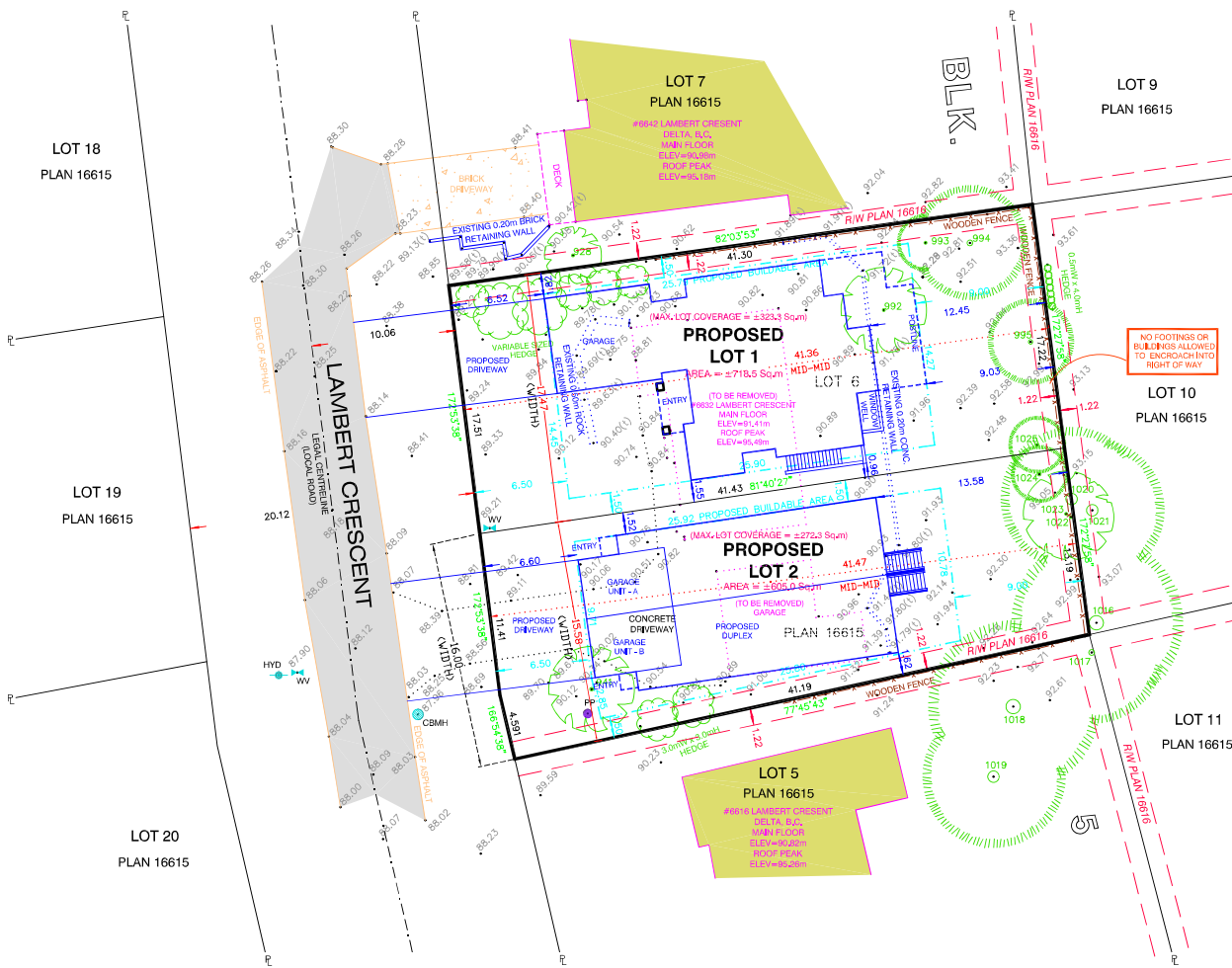

SEC. 13 TP. 4 NWD

THIS PLAN LIES WITHIN THE METRO VANCOUVER REGIONAL DISTRICT
CITY OF DELTA

PROPOSED BUILDING FOOTPRINT ADDED AUGUST 1 2025 (MW)

THIS 6th DAY OF DECEMBER, 2024

Marc Wallace
CP3PWP

MARC WALLACE (1048) B.C.L.S.

FILE: 41231P5D1 DATE: 2025/08/01 MAP: DELTA

SERVER: \JOBS\41231\DWGS\TP\41231P5D1_M250_DATA\MAS\41231.dwg 010-186-891 DT